

1738601-1 Product Details

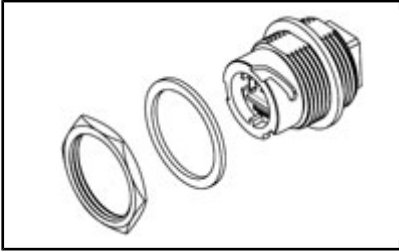

1738601-1



Active

Circular Sealed RJ-45 Connectors



[Always EU RoHS/ELV Compliant \(Statement of Compliance\)](#)

Product Highlights:

- Receptacle Kit
- Mount Type = Panel Mount

[View all Features](#) | [Find Similar Products](#)

NEW!

Documentation & Additional Information

Product Drawings:

- [RECEPTACLE KIT, INDUSTRIAL CIRCULAR ETHERNET CONNECTOR](#) (PDF, English)

Catalog Pages/Data Sheets:

- [Industrial Circular Ethernet-Sealed RJ-45 Connectors](#) (PDF, English)

Product Specifications:

- None Available

Application Specifications:

- [Industrial Circular Ethernet Connector System](#) (PDF, English)

Instruction Sheets:

- [Industrial Circular Ethernet Connector System](#) (PDF, English)

CAD Files: [\(CAD Format & Compression Information\)](#)

- [2D Drawing](#) (DXF, Version B1)
- [3D Model](#) (IGES, Version B1)
- [3D Model](#) (STEP, Version B1)

Additional Information:

- [Product Line Information](#)

Related Products:

- [Tooling](#)

[List all Documents](#)

Product Features (Please use the Product Drawing for all design activity)

Product Type Features:

- Product Type = Receptacle Kit
- Wiring Pattern = RJ45
- Coupling Nut Material = Brass

Termination Related Features:

- Interface Type = Open Device-Net Vendors Association (ODVA)

Body Related Features:

- Mount Type = Panel Mount
- Wire Type = Solid

Contact Related Features:

- Contact Material = Phosphor Bronze
- Contact Plating = Gold over Nickel

Housing Related Features:

- Housing Material = Thermoplastic
- Housing Color = Clear

Industry Standards:

- [RoHS/ELV Compliance](#) = RoHS compliant, ELV compliant
- [Lead Free Solder Processes](#) = Not relevant for lead free process
- RoHS/ELV Compliance History = Always was RoHS compliant

Other:

- Brand = Tyco Electronics